

16-3/8" [416mm] CC

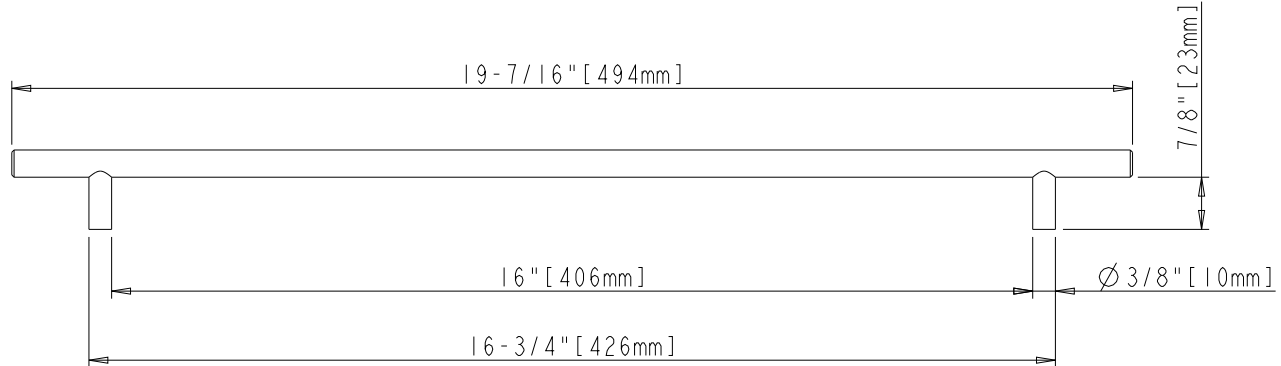

19-7/16" [494mm]

7/8" [23mm]

16" [406mm]

Ø 3/8" [10mm]

16-3/4" [426mm]

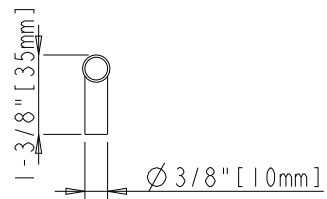

1-3/8" [35mm]

Ø 3/8" [10mm]



Ø 1/2" [12mm]

ACCESSORY:
 SCREW: 8-32X1-1/8" 2PCS
 BREAK AWAY SCREW: 8-32x45 2PCS
 ALL SCREW MATERIAL: STEEL-SAE1006

	ITEM#: 494		MATERIAL: 201 SS	
	Finish:		WEIGHT: 80.7g/0.178lbs	
PROPRIETARY AND CONFIDENTIAL THE INFORMATION CONTAINED IN THIS DRAWING IS THE SOLE PROPERTY OF HARDWARE RESOURCES INC. ANY REPRODUCTION IN PART OR AS A WHOLE WITHOUT THE WRITTEN PERMISSION OF HARDWARE RESOURCES INC. IS PROHIBITED.	TOLERANCE UNLESS OTHERWISE SPECIFIED: X ±0.20 X.X ±0.10 X.XX ±0.05 ANGULAR: ±0.5°		UNITS: DRAWN BY: Alexander.W	DATE: Aug-25-21
DO NOT SCALE DRAWING	SHEET:	APPROVED BY:	RELEASE LEVEL:	DATE:
				REVISION: